

# sea princess

- 1,950 passengers
- 77,000 gross tons
- 856 ft in length
- Fully air conditioned and stabilised
- Bermuda registered

SEA PRINCESS  
 DECK 15  
 DECK 14  
 DECK 13  
 DECK 12  
 DECK 11  
 DECK 10



All staterooms are equipped with private shower and WC, refrigerator, private safe, colour television, multi-channel radio, telephone, hairdryer, individually controlled air-conditioning and twin beds (convertible to queen-size) unless otherwise stated.

**SUN**  
DECK 15

**LIDO**  
DECK 14

**RIVIERA**  
DECK 12

**ALOHA**  
DECK 11

**BAJA**  
DECK 10

**BOW**

**STERN**

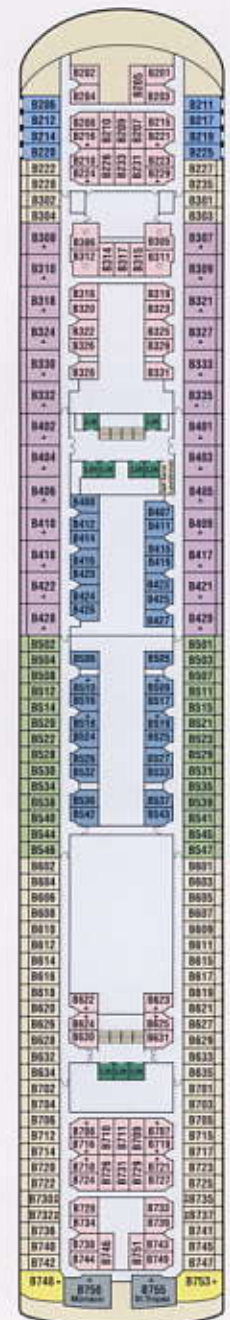
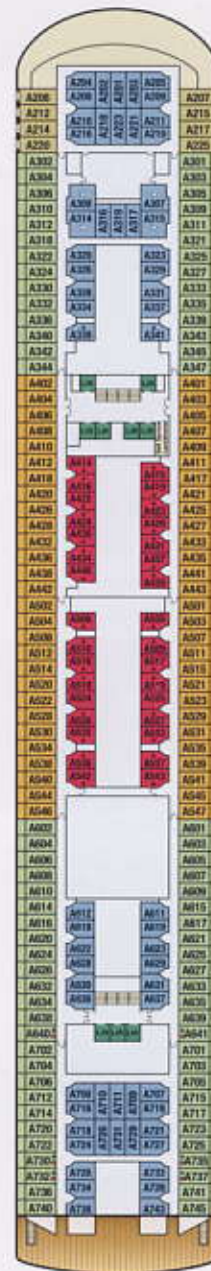
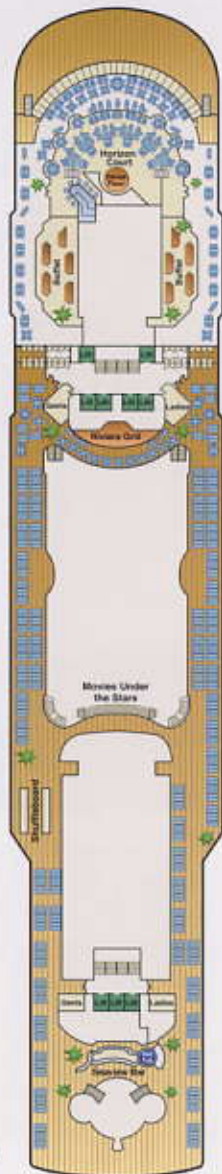

<b>AA</b> BAJA, CARIBE, DOLPHIN: Deluxe suites with verandah	<b>EE</b> DOLPHIN: Twin rooms outside (sloping window)	<b>M</b> PLAZA: Twin rooms inside
<b>AB</b> BAJA, CARIBE, DOLPHIN: Mini-suites with balcony	<b>E</b> EMERALD: Twin rooms outside	<b>N</b> PLAZA: Twin rooms inside
<b>AC</b> BAJA: Mini-suites with balcony	<b>FF</b> PLAZA: Twin rooms outside	<b>THREE &amp; FOUR BERTH STATEROOMS</b>
<b>BA</b> RIVIERA, ALOHA: Deluxe rooms balcony	<b>F</b> PLAZA: Twin rooms outside	<i>Please note that the two lower beds cannot be converted to queen-size when the 3rd/4th beds are in use. 3rd/4th berths may be upper bunks or sofa beds.</i>
<b>BB</b> ALOHA, BAJA: Deluxe rooms balcony	<b>GG</b> DOLPHIN: Twin rooms outside (obstructed view)	□ Wheelchair accessible stateroom
<b>BC</b> BAJA, CARIBE: Deluxe rooms balcony	<b>G</b> DOLPHIN: Twin rooms outside (obstructed view)	● Will accommodate third and fourth person
<b>BD</b> CARIBE: Deluxe rooms balcony	<b>HH</b> DOLPHIN: Twin rooms outside (obstructed view)	▲ Will accommodate third person
<b>BE</b> CARIBE: Deluxe rooms balcony	<b>II</b> RIVIERA, ALOHA: Twin rooms inside	◆ Two lower beds not convertible to queen; shower only
<b>BF</b> CARIBE: Deluxe rooms balcony	<b>I</b> BAJA, ALOHA: Twin rooms inside	◆ Queen bed only
<b>CC</b> ALOHA: Twin rooms outside	<b>JJ</b> CARIBE, BAJA: Twin rooms inside	
<b>C</b> BAJA: Twin rooms outside	<b>K</b> DOLPHIN, CARIBE: Twin rooms inside	
<b>DD</b> CARIBE: Twin rooms outside	<b>L</b> EMERALD, PLAZA: Twin rooms inside	
<b>D</b> DOLPHIN: Twin rooms outside (large sloping window)		

**CARIBE**  
DECK 9



**DOLPHIN**  
DECK 8

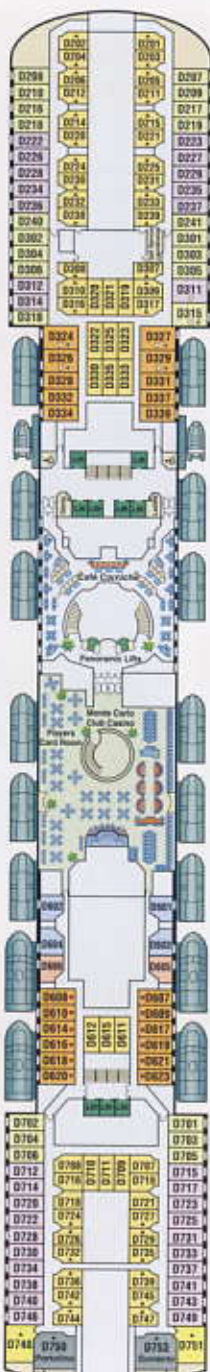

**PROMENADE**  
DECK 7



**EMERALD**  
DECK 6

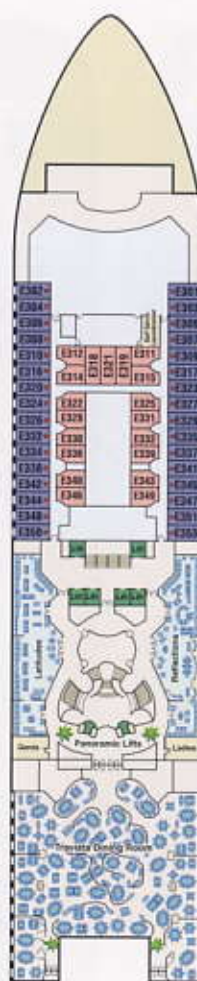

**PLAZA**  
DECK 5

