

QUEEN VICTORIA

Deck plans

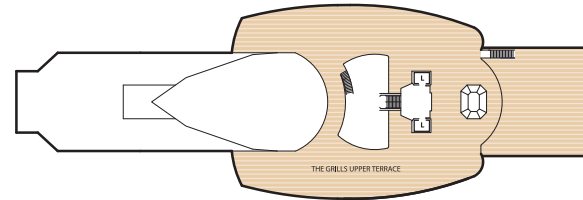

Deck 12

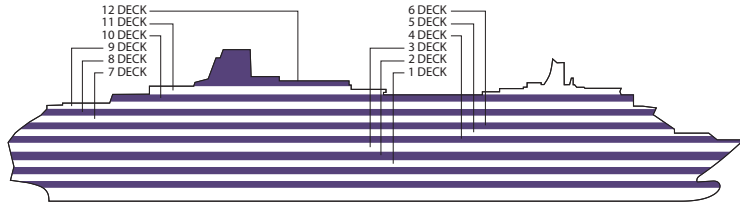
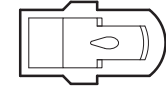

Stateroom Category

Category	Deck
Q1	6, 7
Q2	7
Q3	6, 8
Q4	4, 5
Q5	4, 5, 8
Q6	7
Q7	7
P1	7, 8
P2	5, 6
P3	4
P4	4
A1	8
A2	7, 8
A3	6, 7
A4	5, 6
A5	5
A6	4
A7	4
C1	6
C2	1
C3	1
C4	4
C5	4
D1	6, 8
D2	1
D3	8
D4	7
D5	6
D6	5
D7	4
D8	4

Ship facts	
Country of Registry:	Great Britain
Speed:	23.7 knots
Gross Tonnage:	90,000 GRT
Guest Capacity:	1,970
No. of Crew:	1,100
Length:	964.5 feet
Width:	106 feet
Draft:	25.9 feet

Key to symbols	
L	Lift

At the time of going to press Queen Victoria is under construction. Where necessary Cunard reserves the right to alter deck plans without notice.

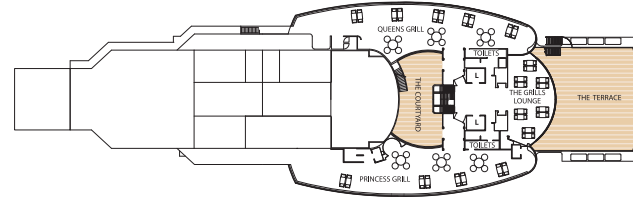

Deck 11

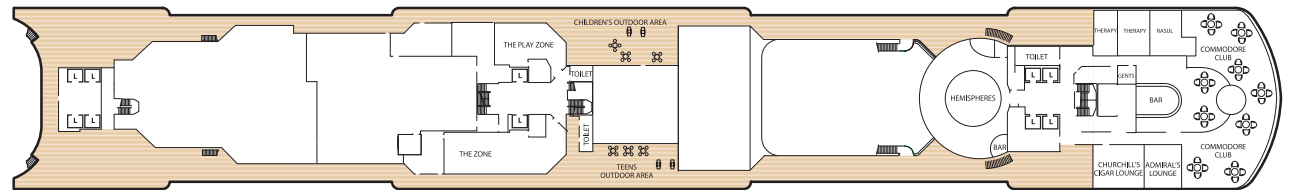
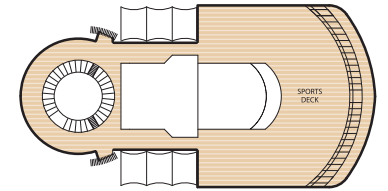

Deck 10

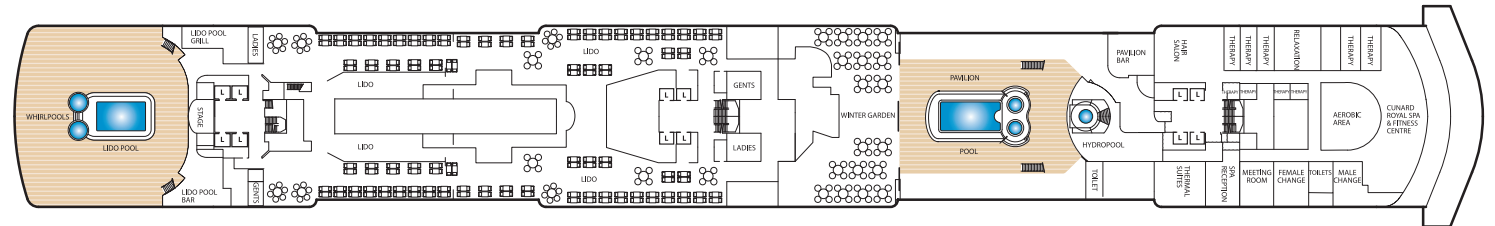

Deck 9

Aft

Midships

Forward



CUNARD

QUEEN VICTORIA

Deck plans

Stateroom Category

Q1	Grand Suites	6, 7
Q2	Master Suites	7
Q3	Penthouse	6, 8
Q4	Penthouse	4, 5
Q5	Queens Suites	4, 5, 8
Q6	Queens Suites	7
Q7	Queens Suites	7
P1	Princess Suites	7, 8
P2	Princess Suites	5, 6
P3	Princess Suites	4
P4	Princess Suites	4
A1	Balcony	8
A2	Balcony	7, 8
A3	Balcony	6, 7
A4	Balcony	5, 6
A5	Balcony	5
A6	Balcony	4
A7	Balcony	4
C1	Oceanview	6
C2	Oceanview	1
C3	Oceanview	1
C4	Oceanview*	4
C5	Oceanview*	4
D1	Deluxe Inside	6, 8
D2	Deluxe Inside	1
D3	Standard Inside	8
D4	Standard Inside	7
D5	Standard Inside	6
D6	Standard Inside	5
D7	Standard Inside	4
D8	Standard Inside	4

Deck

Key to symbols	
†	Indicates 2 lower berths and 1 upper berth (The location of these 3rd staterooms is provisional)
+	Indicates 3rd berth is a single sofa bed
▲	Wheelchair accessible
L	Lift
*	C4 & C5 Staterooms have views obstructed by lifeboats
◆	Staterooms 6003 & 6004 have forward facing oceanviews

Deck 8 (Penthouses, Queens and Princess Suites and Staterooms 8.001-8.166)

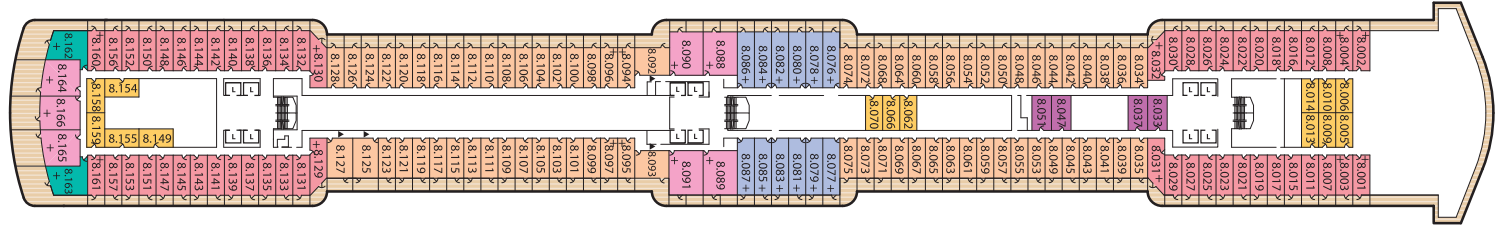

Deck 7 (Grand, Master, Queens and Princess Suites and Staterooms 7.001-7.159)

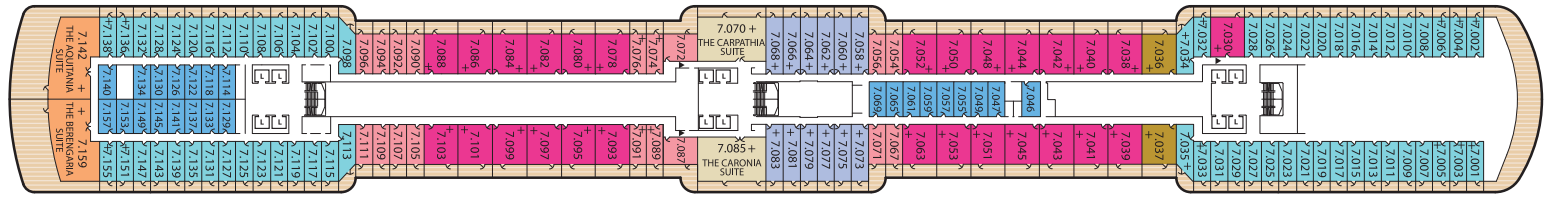

Deck 6 (Grand Suites, Penthouses, Princess Suites and Staterooms 6.001-6.203)

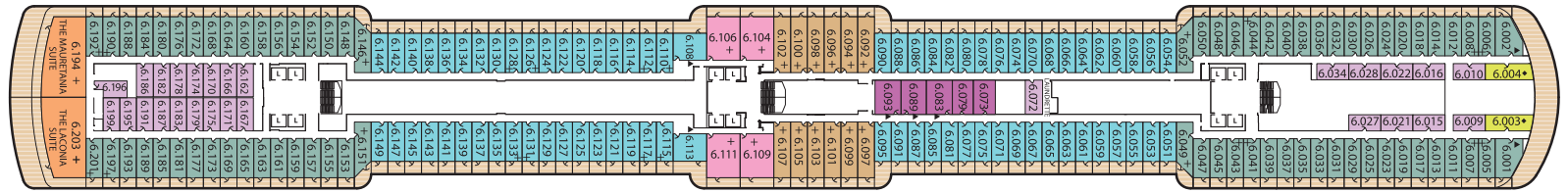

Deck 5 (Penthouses, Queens and Princess Suites and Staterooms 5.001-5.196)

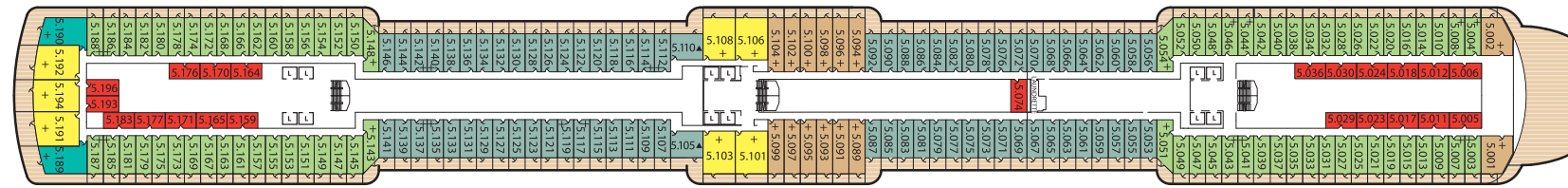

Aft

Midships

Forward

At the time of going to press Queen Victoria is under construction. Where necessary Cunard reserves the right to alter deck plans without notice.



Stateroom Category

Category	Deck	
Q1	Grand Suites	6, 7
Q2	Master Suites	7
Q3	Penthouse	6, 8
Q4	Penthouse	4, 5
Q5	Queens Suites	4, 5, 8
Q6	Queens Suites	7
Q7	Queens Suites	7
P1	Princess Suites	7, 8
P2	Princess Suites	5, 6
P3	Princess Suites	4
P4	Princess Suites	4
A1	Balcony	8
A2	Balcony	7, 8
A3	Balcony	6, 7
A4	Balcony	5, 6
A5	Balcony	5
A6	Balcony	4
A7	Balcony	4
C1	Oceanview	6
C2	Oceanview	1
C3	Oceanview	1
C4	Oceanview*	4
C5	Oceanview*	4
D1	Deluxe Inside	6, 8
D2	Deluxe Inside	1
D3	Standard Inside	8
D4	Standard Inside	7
D5	Standard Inside	6
D6	Standard Inside	5
D7	Standard Inside	4
D8	Standard Inside	4

Deck 4 (Penthouses, Queens and Princess Suites and Staterooms 4.001-4.192)

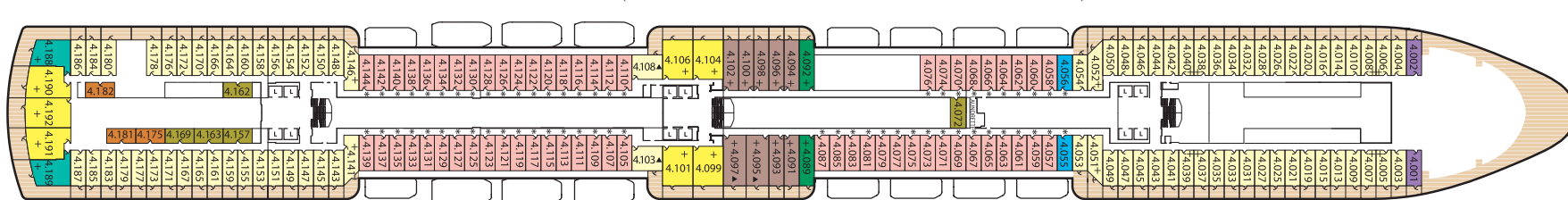

Deck 3

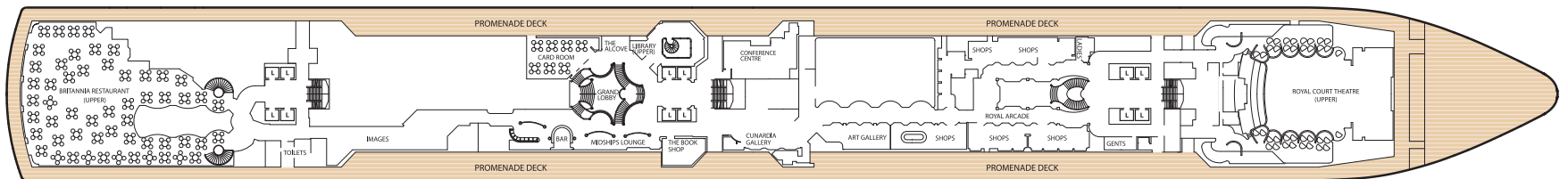

Deck 2

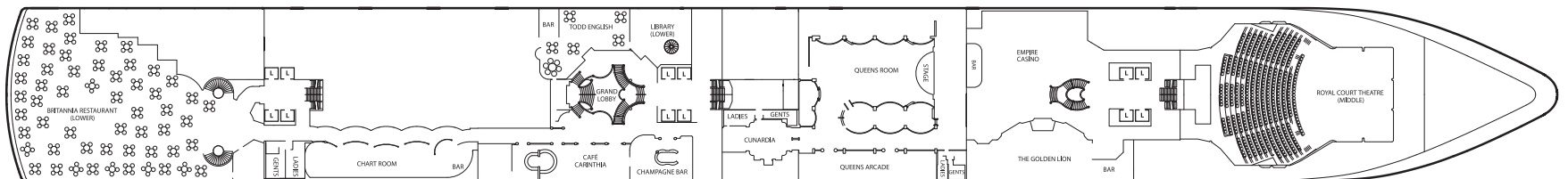

Deck 1 (Staterooms 1.001-1.113)

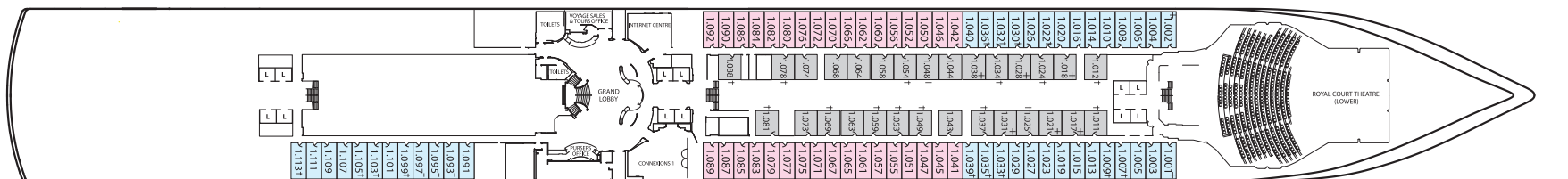

Aft

Midships

Forward