

Gross Tonnage: 70,367 Length: 855 Feet Beam: 103 Feet Cruising Speed: 21 Knots
 Guest Capacity: 2,052 (Double Occupancy) Total Staff: 920 Registry: The Bahamas

Accommodation Symbol Legend

- 2 Uppers
- 1 Upper
- ★ Twin Bed/King and Single Convertible Sofa
- † Twin Bed/King and Double Convertible Sofa
- ◆ Stateroom with 2 Porthole Windows
- ◁ Connecting Staterooms (Ideal for families and groups of friends)
- U Unisex Wheelchair Accessible Restroom

11 Suites with obstructed views: V21, V23, V25, V27, V30, V34, V38, V42.

Staterooms are available that are modified for wheelchair users. Please contact Carnival Reservations Department, Guest Access Services, at 1-800-438-6744, ext. 70025, for details. Even-numbered Interior staterooms exit port side (left); odd-numbered Interior staterooms exit starboard (right).

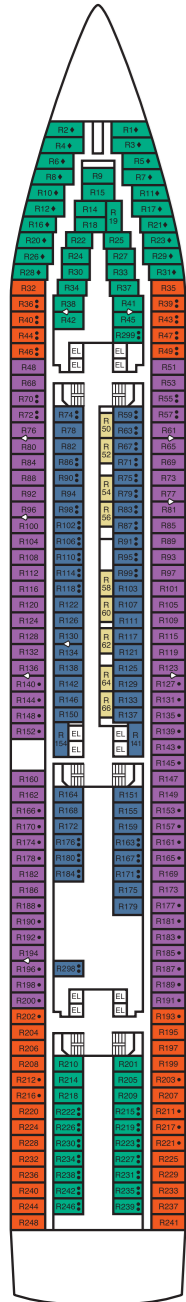

Riviera • Deck 4

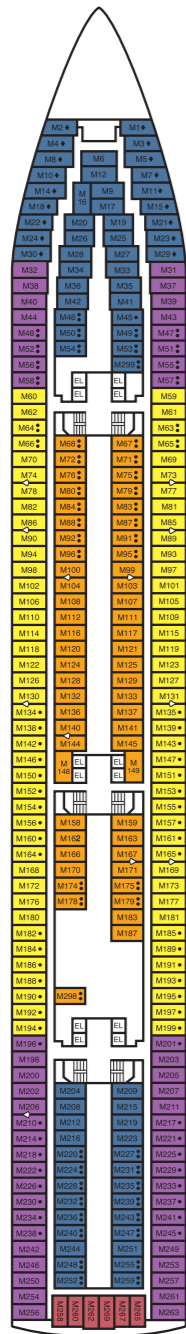

Main • Deck 5

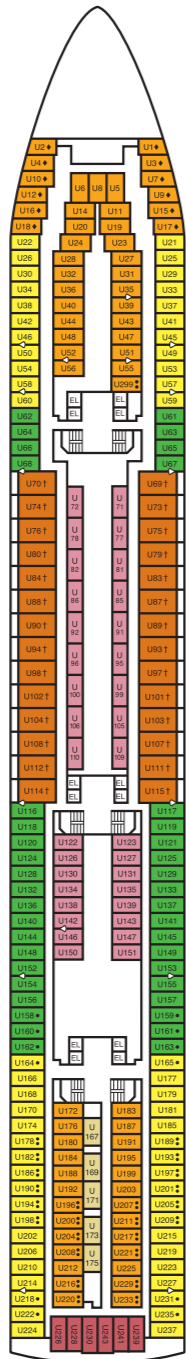

Upper • Deck 6



Empress • Deck 7

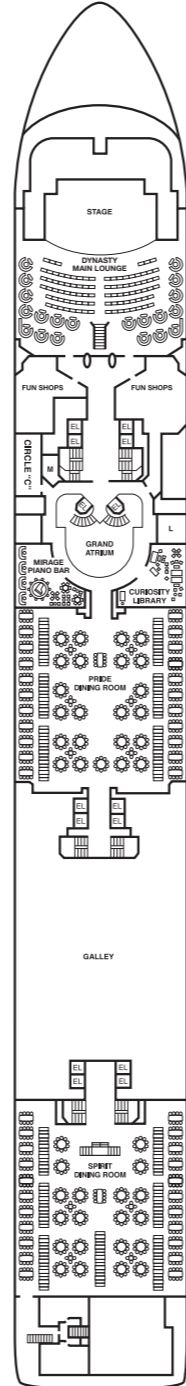

Atlantic • Deck 8

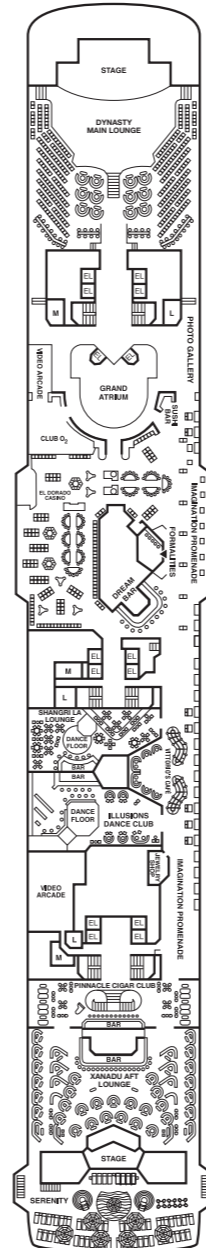

Promenade • Deck 9

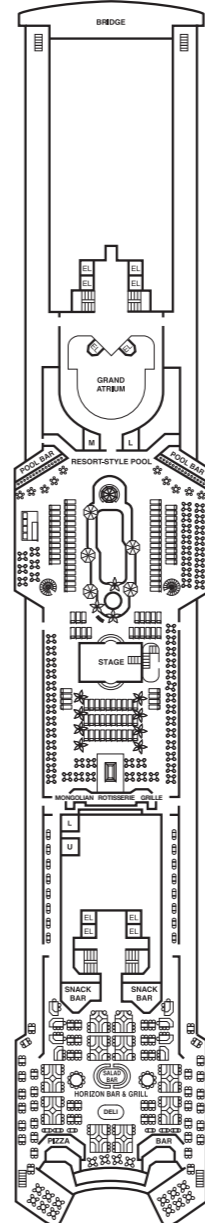

Lido • Deck 10

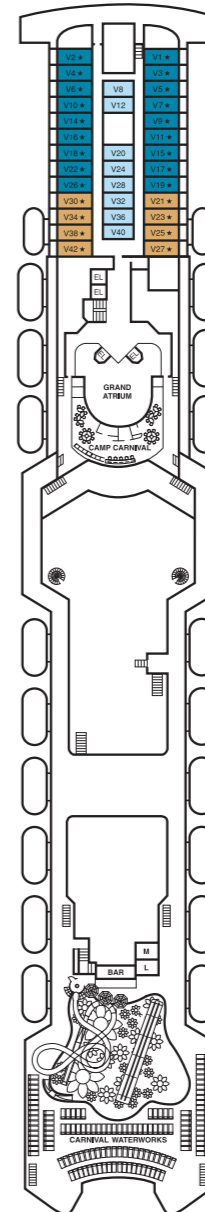

Verandah • Deck 11



Forward Sports • Deck 12

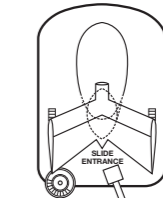

Aft Sports • Deck 12

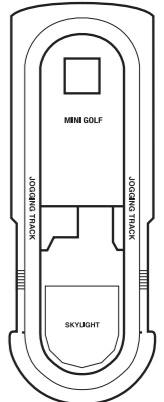

Sun • Deck 14



Categories:
 Interior: 4A, 4B, 4C, 4D, 4E, 4F
 Interior Upper/Lower: 1A (not pictured): Feature upper and lower beds



Categories:
 Ocean View: 6A, 6B, 6C, 6D, 6E



Categories:
 Suite: 111, 11 (obstructed views)



Category:
 Penthouse Suite: 12